

G-MAX & Power Gravity Fill Valve

TOILET TANK FILL VALVE INSTRUCTIONS

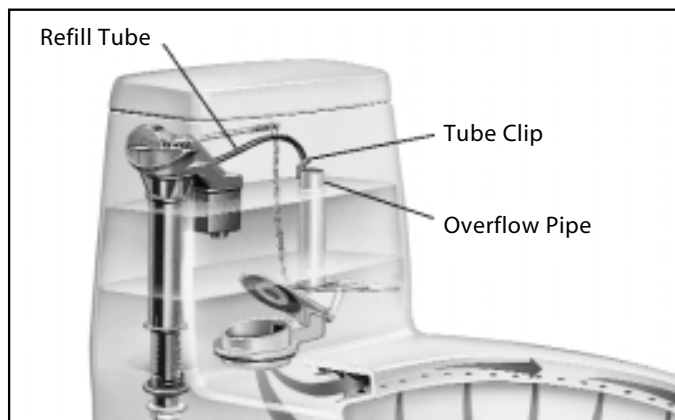

Note: The Fill Valve Level is set at the factory. **This setting should not be changed.** For assistance with the correct setting, please call Technical Support at the number below.

WATER LEVEL ADJUSTMENT

1. To adjust, simply turn upper half of valve counter-clockwise to unlock, pull up til water level is where the water line is marked on the overflow pipe, Fig. A, then turn clockwise till valve snaps into locked position.

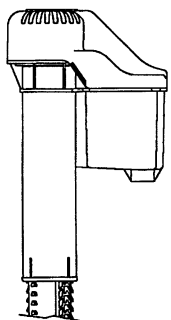

Fig. A

2. Turn on water supply to fill tank. 3. T proof key is optional, and may be used simply to prevent further adjustment once final setting is achieved, Fig. B.

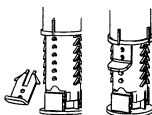

Fig. B

INSTALLATION

1. Shut off water supply. Flush toilet; sponge remaining water from tank. Remove old ballcock.

2. Slide threaded valve-shaft through hole in bottom of tank. Note: Be sure to install valve in the locked position at the angle shown in Fig. C. Thread mounting-nut onto exposed shaft under tank and tighten nut.

DO NOT OVERTIGHTEN.

3. Connect water supply as shown in Fig. D. Pipe dope is not recommended. Hand tight only; do not overtighten coupling nut. 4. Finally attach refill tube to valve and clip other end to overflow pipe.

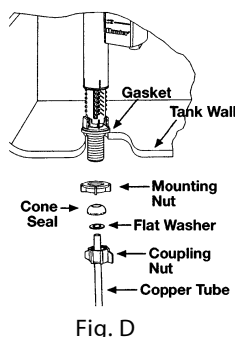
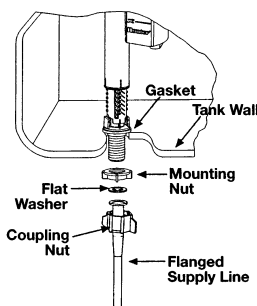

Fig. D



SERVICING INSTRUCTIONS

NOTE: The Fill Valve will need periodic cleaning to remove debris found in the water line. An indication that the fill valve needs to be serviced can be heard in strange noises emitting from the fill valve at the end of the fill cycle. Another sign is the fill valves inability to turn off. Typically, the fill valve needs to be serviced once a year to insure proper operation. For well-water systems or aggressive water conditions, service the fill valve more frequently.

1. Turn off water supply, then flush toilet. Remove the rubber refill tube from the fill valve.

2. Snap off cover.

3. Gently press float arms inward and remove float.

4. While holding valve with one hand, twist cap 1/8 turn counter clockwise and remove.

5. Lift out center tube as shown. Slowly turn the water supply back on. Run water through the fill valve, until it is free from debris. Cover the water that sprays from the fill valve with your hand or a small cup. Shut the water supply off.

6. Remove strainer from center tube as shown. Clean strainer and cap by rinsing off under faucet.

7. Carefully reassemble the valve in the reverse order. When properly assembled the ribs of the cap are in line with the float chamber and the refill port is aligned as shown.

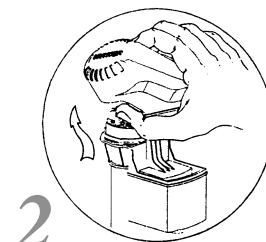

2



3

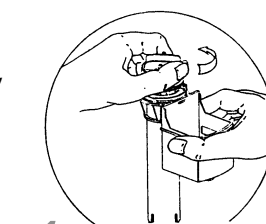

4

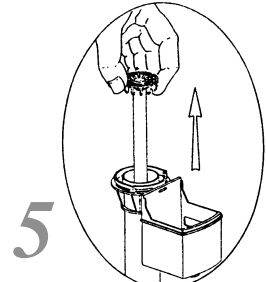

5

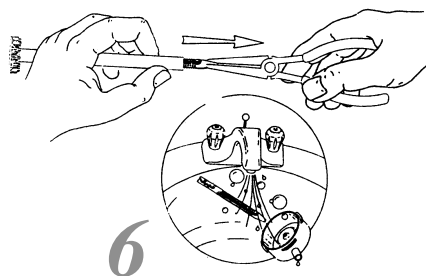

6

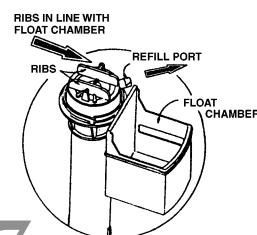

7