



OPTICA™

DECK MOUNT/HAND HELD SHOWER INSTALLATION INSTRUCTIONS

1. Drill a 1 -1/4" diameter hole in the deck not more than 18" from the water supply.
2. Install hose guide through the 1 -1/4" diameter hole as shown.
3. Apply an 1/8" bead of sealant to the bottom surface of the flange.
4. Tighten onto hose guide threads (be sure that the flats inside the flange are perpendicular to the rim of the rib.)
5. Connect water supply stainless steel hose (not provided) to 59" Flex-Hose, Elbow and Hand Held Shower.

Note: Be sure that your water supply hose extends through the hose guide. This will make replacement of the Flex-Hose easier if necessary.

Proper Installation of the fill spout and compliance with local codes is the responsibility of the installer. Jacuzzi Whirlpool Bath does not warrant connections of water supply fittings and piping, fill systems, or drain/overflow systems. Nor is it responsible for damage to the bath (or spa) which occurs during any installation procedure.

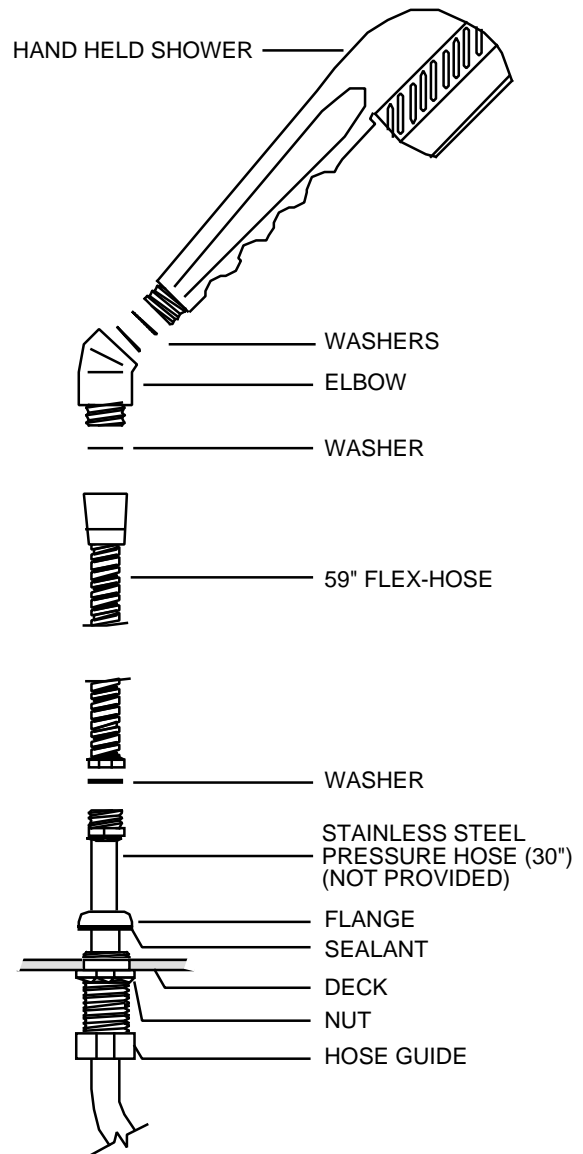

CAUTION

Since plumbing fittings may contribute detectable amounts of lead to water, the following notice is required by California law (Proposition 65). "This product contains a chemical known to the State of California to cause birth defects or reproductive harm." In normal use, any lead exposure can be minimized by allowing the water to run free for several seconds before drinking.

JACUZZI WHIRLPOOL BATH

Jacuzzi Whirlpool Bath National Headquarters

P.O. Drawer J, Walnut Creek, CA 94596 (510) 938-7070

Customer Service: Call (510) 938-7411

©1994 Jacuzzi Whirlpool Bath C972000 02/94



Printed on Recycled Paper

Printed in U.S.A.