



Optional Gas Heater for the Cirrus/Santina™ Spa

INSTALLATION INSTRUCTIONS

Read all instructions before beginning conversion.

A gas heater is available from your Jacuzzi Whirlpool Bath dealer for use on your Cirrus/Santina™ spa as an optional feature and additional heat source offering a faster heat rise than the integrated electric heater provided on the spa. We recommend that the heater selected have a rating less than 160,000 BTU's.

Converting to gas heat will involve some electrical wiring, providing a gas line, and modifications to the spa plumbing and to the redwood skirt. We recommend that you hire a qualified spa installer or licensed contractor to perform this conversion if you are not equipped to do so.

IMPORTANT: Locate the heater at least 5 ft., but not farther than 20 ft. away from the spa; make sure the base of the heater is on the same level as the base of the spa. Refer to the manufacturer's installation instructions for proper placement and clearance around the heater as well as specific plumbing and electrical details.

IMPORTANT

Proper installation of an optional heater and compliance with local codes is the responsibility of the installer. Jacuzzi Whirlpool Bath does not warrant optional heaters or connections of optional heaters, nor is it responsible for damage to the spa which occurs during any installation procedure. See gas heater manufacturer's warranty packed with the heater.

Preparation:

1. Unplug the spa power cord, or turn off the power to the spa at the main service panel if the spa is converted to 230 VAC.
2. Drain the spa completely.
3. Temporarily remove the redwood skirt panel shown in Illustration A. To do this, remove all six Phillips® type screws securing the front and right side skirt panels.

Installing the Gas Heater:

1. Prepare the optional heater installation site according to the heater manufacturer's instructions. Make sure the heater is located so the interconnecting piping between the spa and the heater will pass through the panel removed above.
2. Cut the spa heater loop per detail in Illustration B and discard PVC scraps.
3. Interconnecting piping between the heater and the spa should be 2" min. Sch. 40 PVC. We recommend that you use at least 4 feet of copper 1-1/2" copper pipe at both the inlet and outlet connections on the heater. **Use as few fittings and bends as possible, and avoid any vertical or elevated horizontal piping configurations which would trap air.** If a chlorinator is to be used, install a check valve, and install chlorinator in the return line from the heater to the spa, after the check valve. Follow chlorinator manufacturing at the gas heater, **dry fit** the piping up to the spa. (See Illustration C.)
4. Starting at the gas heater, **dry fit** the piping up to the spa. (See Illustration C.)

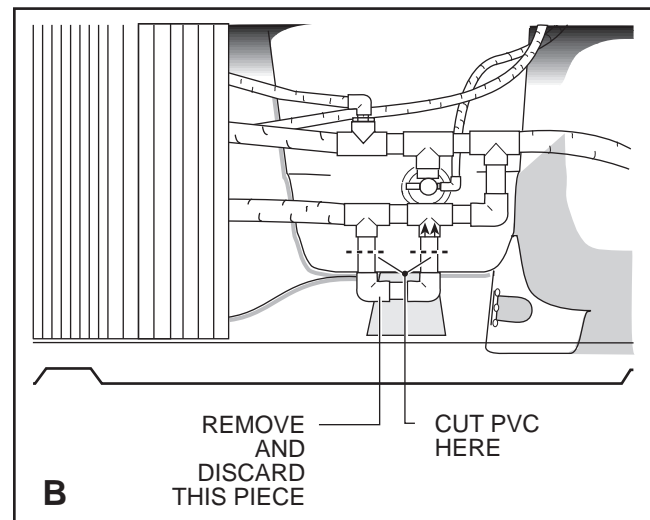
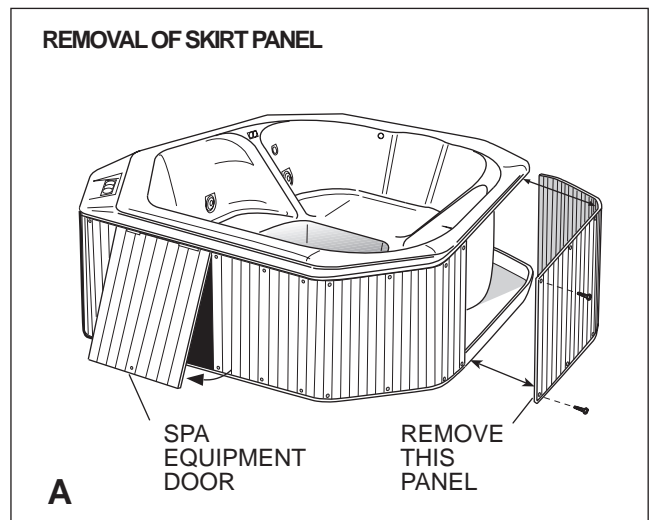

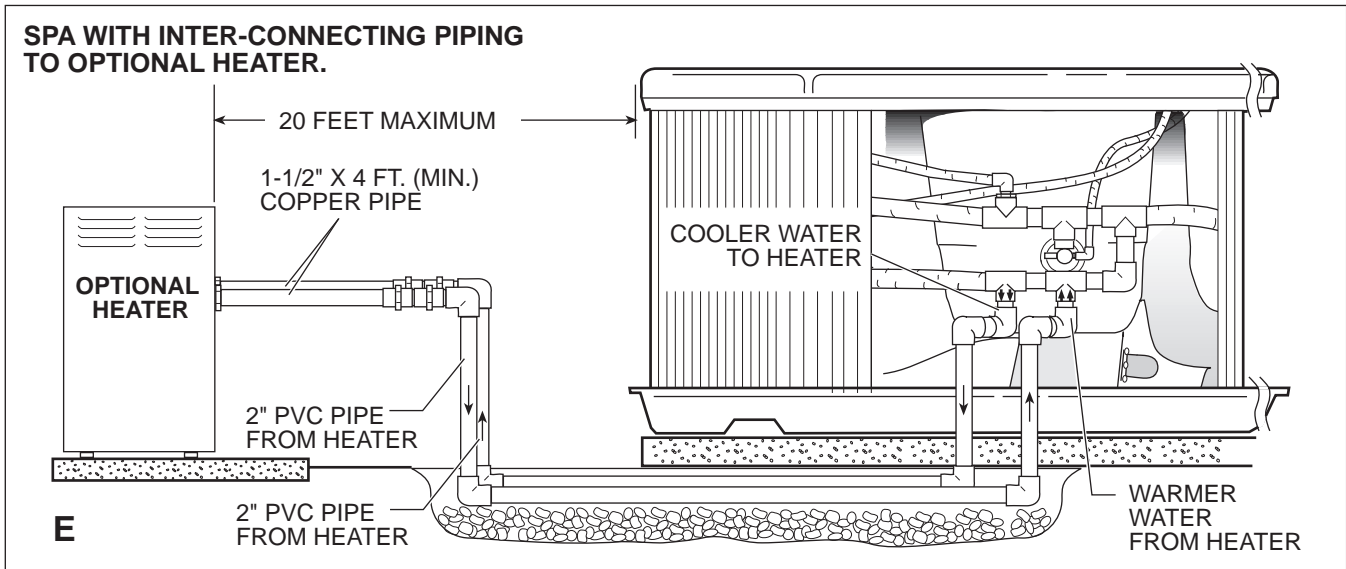

(This illustration is merely a suggested plumbing layout. Actual installation sites will vary.)

5. Before connecting piping from the optional heater to the plumbing on the spa, reinforce the skirt panel removed in step 3 with a 12" x 12" x 3/8" sheet of plywood at the point where the piping will pass through. Secure the plywood to the inside of the skirt with short nails and waterproof construction adhesive. After the glue has set, cut a hole in the skirt and the plywood backing large enough to accommodate the heater inlet and outlet pipes, plus 1" all around. See Illustration D.
6. Re-install the modified skirt panel.
7. Cement dry-fitted interconnecting piping and connect and glue inlet piping to the left PVC pipe stub on the spa; connect and cement return piping to the PVC pipe stub on the right. (See Illustration C.)

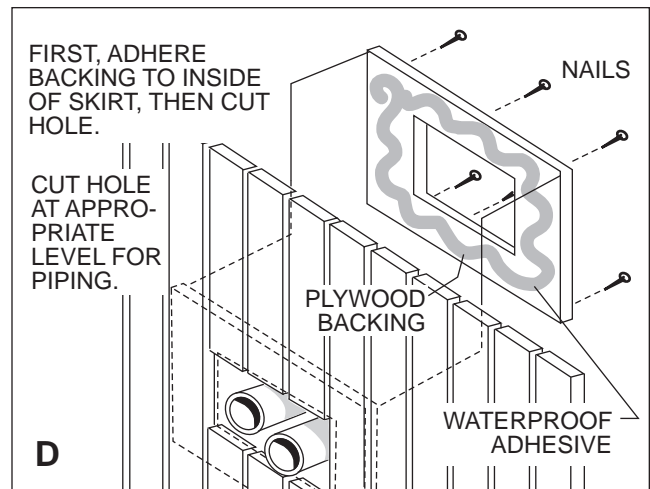

Operation:

1. Fill the spa with water. Check for leaks
2. Turn on power to the spa at the main service panel.
3. Adjust the spa thermostat on the Cirrus control panel per instructions in the Owner's Manual.
4. Adjust the thermostat on the gas heater as follows:
 - a. Set System Switch to FILTER mode.
 - b. Set the gas heater thermostat to its maximum setting.
 - c. When the spa water reaches the desired temperature set in step 3, turn the gas heater thermostat down until the gas heater turns off.
 - d. Mark the point (at which the heater turns off) on the gas heater thermostat dial for future reference. **DO NOT INCREASE THE SETTING PAST THE POINT. LOCK IN PLACE IF POSSIBLE.**

CAUTION: In the JETS or FILTER mode, the spa water will heat to the highest temperature setting on the gas heater thermostat. In the HTR/FILTER mode, however, the spa thermostat alone governs the water temperature. To ensure that the water temperature will not exceed the desired temperature, adjust the gas heater thermostat according to step 4 above.

5. If the gas heater is equipped with a pressure switch, adjust the pressure setting according to the manufacturer's instructions. The pressure switch is properly adjusted if the heater is operational when the filter pump and/or whirlpool pump is running.

Note: In some applications, the gas heater's pressure switch may not adjust to a low enough setting to allow the gas heater to operate while in FILTER or HTR/FILTER mode. A flow switch may be added to the plumbing to replace the pressure switch contained within the heater. Contact the heater manufacturer for recommendations.

6. Test the system for proper operation.

